

NATURE'S HAMMOCK, PHASE 3

LOCATED IN SECTIONS 4,5,&8
TOWNSHIP 6 SOUTH, RANGE 12 EAST
LAFAYETTE COUNTY, FLORIDA

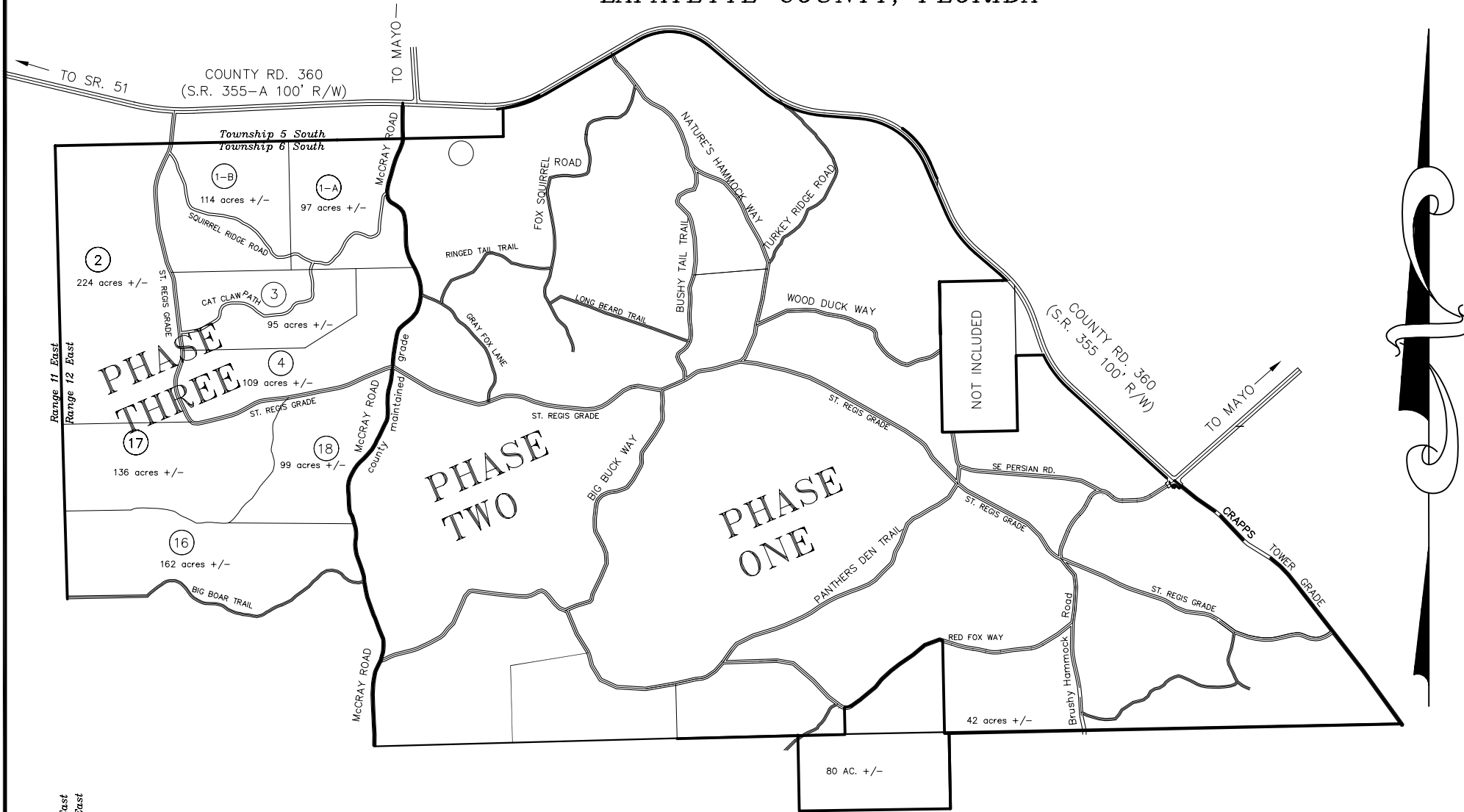

SKETCH OF PHASE 2 FOR INFORMATIONAL PURPOSE ONLY, NOT A BOUNDARY SURVEY

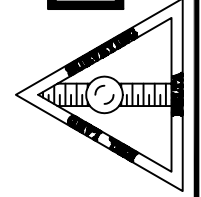

DELTA

LAND SURVEYORS, INC.

CERTIFICATE OF AUTHORIZATION NUMBER LB 4765
114 WEST GREEN STREET
PERRY, FLORIDA 32347

PHONE (850) 584-2849

FAX(850) 584-7609

JUNE 28, 2006

DATE

05-210-42

JOB NO.

Range 11 East
Range 12 East

Range 11 East
Range 12 East